

# NEW PRODUCT NEWS



Taegutec Milling Line

## MAXISPEED



**QUICK HEAD CHANGEABLE  
MODULAR MILLING LINE EXPANDED**

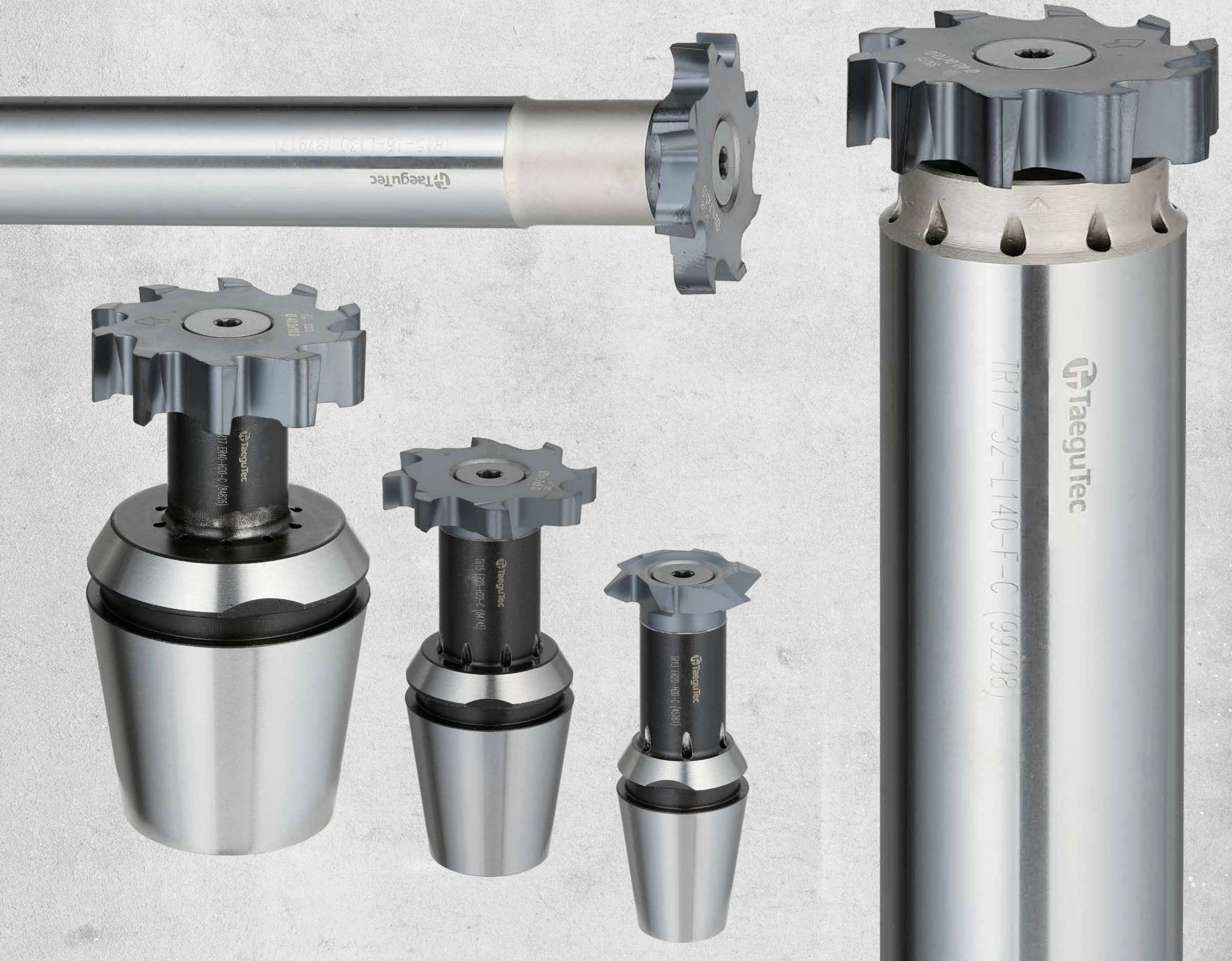







### KEY POINT

**TaeguTec's head changeable MAXI-SFEED line introduces the ER Collet adaptor.**

The slotting, facing, and threading MAXI-SFEED line's easy head change system enhances production thanks to a one screw mounting that reduces set-up time. TaeguTec has now released an extra ER collet adaptor that is compatible with a wide range of collet chucks.

Further changes to the line include updating the TR17 shank's screw and wrench to improve efficiencies in stock delivery. The updated screw and wrench will be available after the current inventory runs out.

### MAXI-SFEED product line

Carbide head	 <p>TR-S For slotting</p>	 <p>TR-F For facing</p>	 <p>TR-T For threading</p>
Holder	 <p>TR-S For slotting and threading</p>	 <p>TR-F-C For facing</p>	 <p>TR-ER-C For ER collet</p>

## Taegutec Milling Line

Compatible with various head types

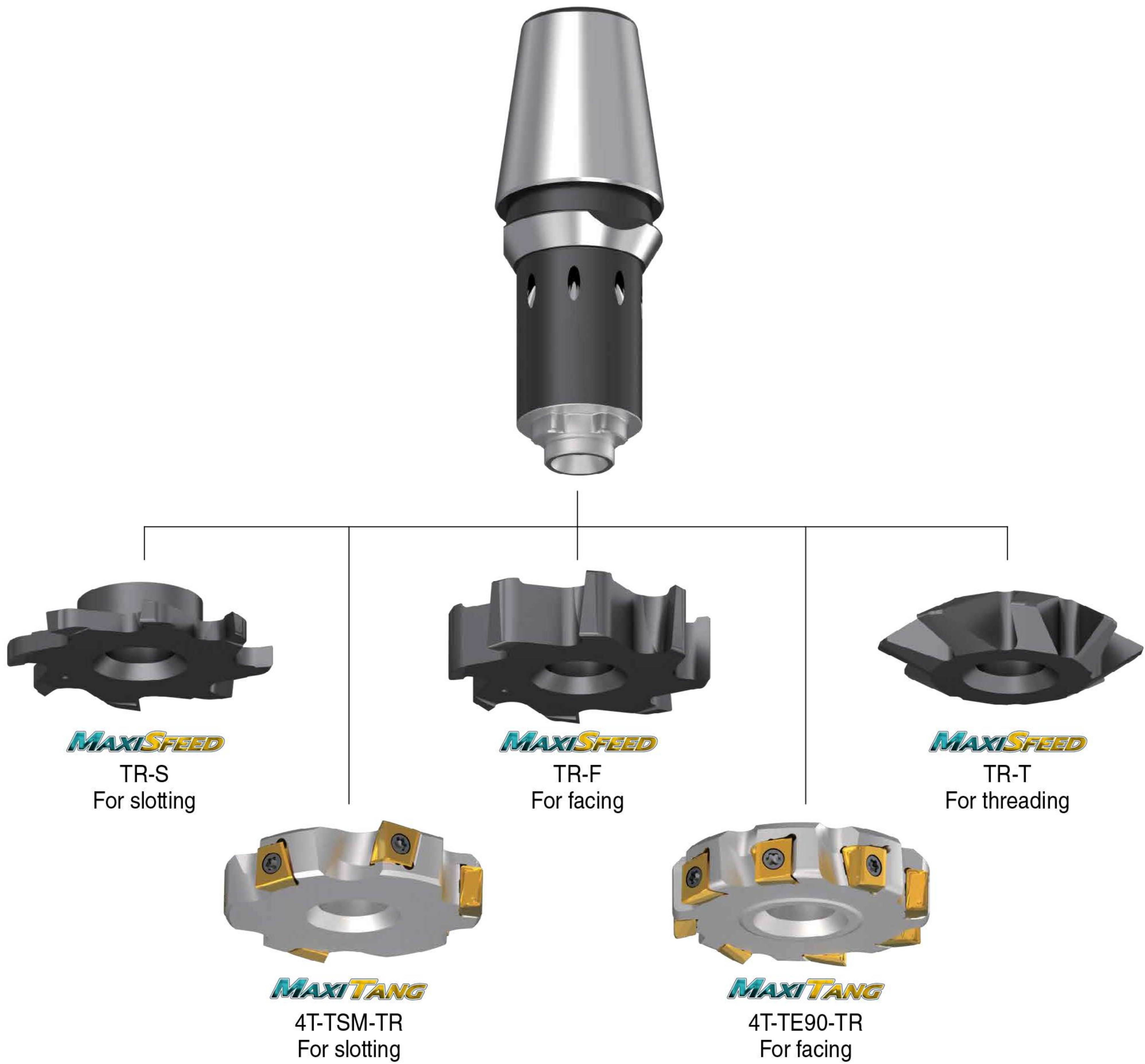

## Taegutec Milling Line

### TR-S



#### Interchangeable solid carbide slot milling heads

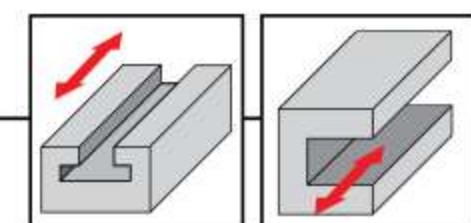
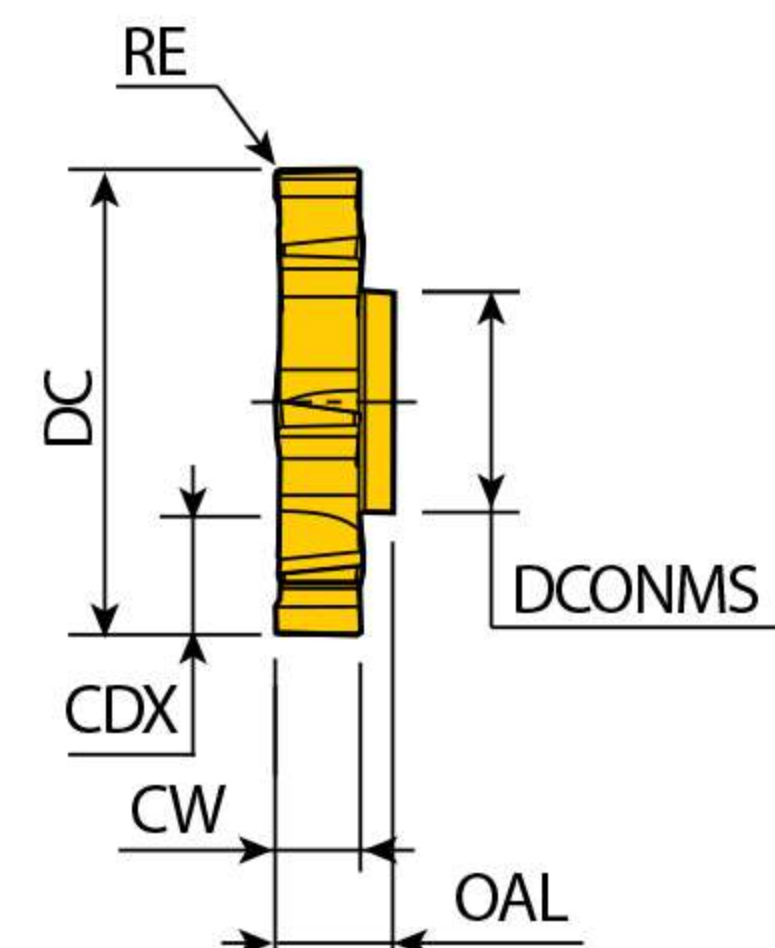
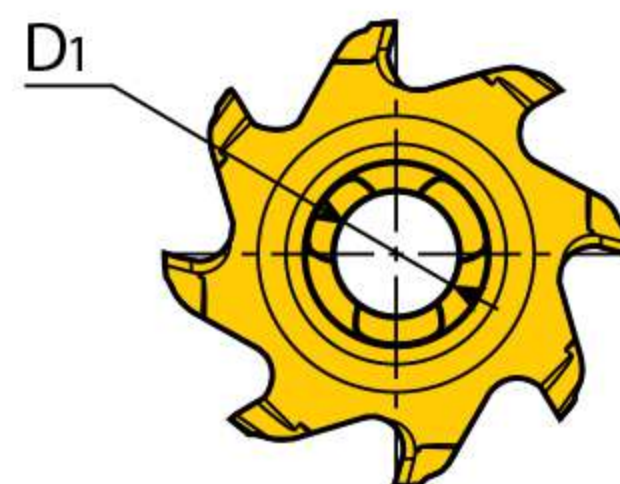

Designation	Feed (mm/tooth)	Dimension (mm)								Grade
		DC	CW	CDX	NOF	RE	D1	DCONMS	OAL	
<b>TR13-S-24.7-3.0R0.4</b>	0.02-0.15	24.7	3	5.5	6	0.4	7.5	13	8	•
<b>24.7-4.0R0.4</b>	0.02-0.15	24.7	4	5.5	6	0.4	7.5	13	8	•
<b>24.7-5.0R0.4</b>	0.02-0.15	24.7	5	5.5	6	0.4	7.5	13	8	•
<b>24.7-6.0R0.4</b>	0.02-0.15	24.7	6	5.5	6	0.4	7.5	13	8	•
<b>24.7-7.0R0.4</b>	0.02-0.15	24.7	7	5.5	6	0.4	7.5	13	8	•
<b>24.7-8.0R0.4</b>	0.02-0.15	24.7	8	5.5	6	0.4	7.5	13	8	•
<b>TR15-S-31.7-3.0R0.4</b>	0.022-0.18	31.7	3	8.0	8	0.4	8.4	15	8	•
<b>31.7-4.0R0.4</b>	0.022-0.18	31.7	4	8.0	8	0.4	8.4	15	8	•
<b>31.7-5.0R0.4</b>	0.022-0.18	31.7	5	8.0	8	0.4	8.4	15	8	•
<b>31.7-6.0R0.4</b>	0.022-0.18	31.7	6	8.0	8	0.4	8.4	15	8	•
<b>31.7-7.0R0.4</b>	0.022-0.18	31.7	7	8.0	8	0.4	8.4	15	8	•
<b>31.7-8.0R0.4</b>	0.022-0.18	31.7	8	8.0	8	0.4	8.4	15	8	•
<b>TR17-S-39.7-4.0R0.4</b>	0.025-0.20	39.7	4	11.0	10	0.4	9.8	17	10	•
<b>39.7-5.0R0.4</b>	0.025-0.20	39.7	5	11.0	10	0.4	9.8	17	10	•
<b>39.7-6.0R0.4</b>	0.025-0.20	39.7	6	11.0	10	0.4	9.8	17	10	•
<b>39.7-7.0R0.4</b>	0.025-0.20	39.7	7	11.0	10	0.4	9.8	17	10	•
<b>39.7-8.0R0.4</b>	0.025-0.20	39.7	8	11.0	10	0.4	9.8	17	10	•
<b>39.7-9.0R0.4</b>	0.025-0.20	39.7	9	11.0	10	0.4	9.8	17	10	•
<b>39.7-10.0R0.4</b>	0.025-0.20	39.7	10	11.0	10	0.4	9.8	17	10	•

• NOF: Number of flutes

•: Standard items

## Taegutec Milling Line

### TR-F

**MAXISPEED**

Interchangeable solid carbide facing heads

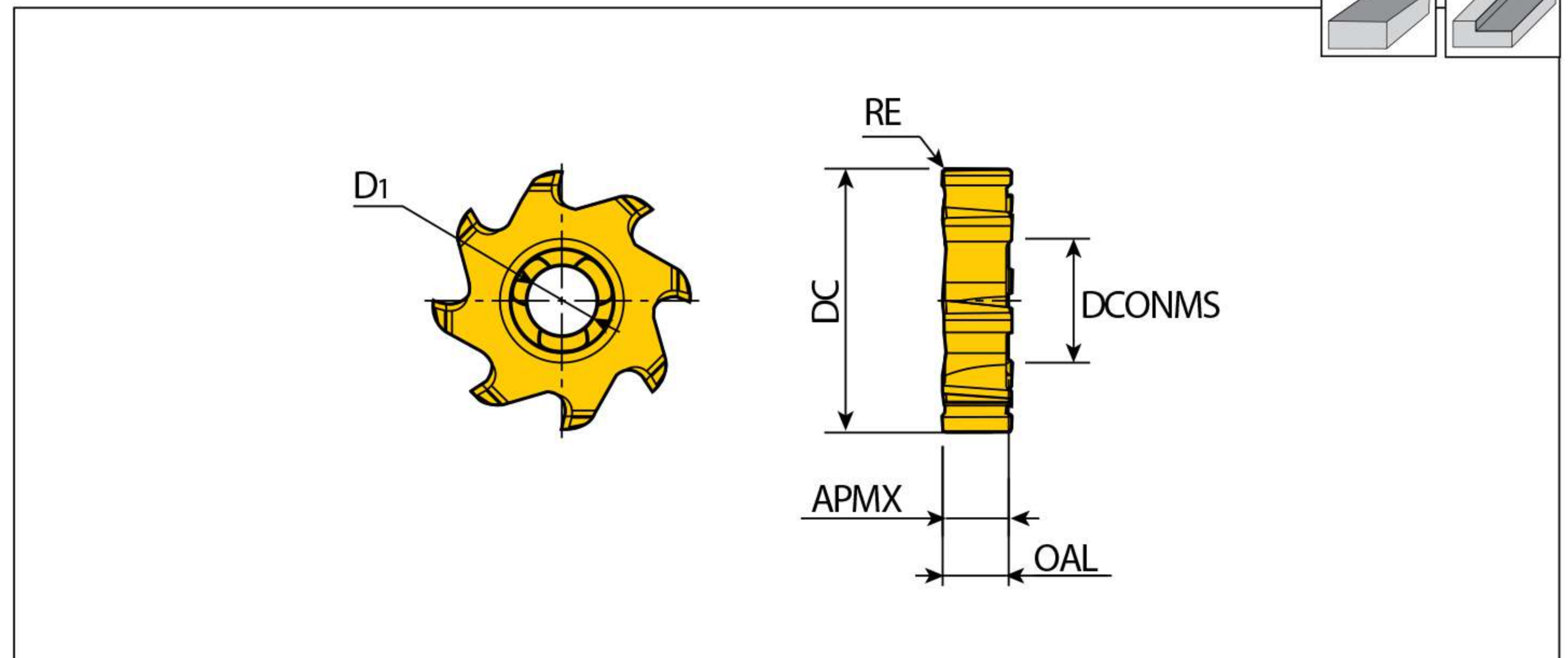

Designation	Feed (mm/tooth)	Dimension (mm)							Grade
		DC	APMX	NOF	RE	D1	DCONMS	OAL	
<b>TR 13-F-25-8.0-R0.4</b>	0.04-0.15	24.25	8	6	0.4	7.5	13	8	●
<b>15-F-32-8.0-R0.4</b>	0.04-0.15	31.25	8	8	0.4	8.4	15	8	●
<b>17-F-40-10.0-R0.4</b>	0.04-0.15	39.25	10	10	0.4	9.8	17	10	●

● NOF: Number of flutes ● : Standard items

### TR-T-W55



Interchangeable solid carbide threading heads - 55° partial profile

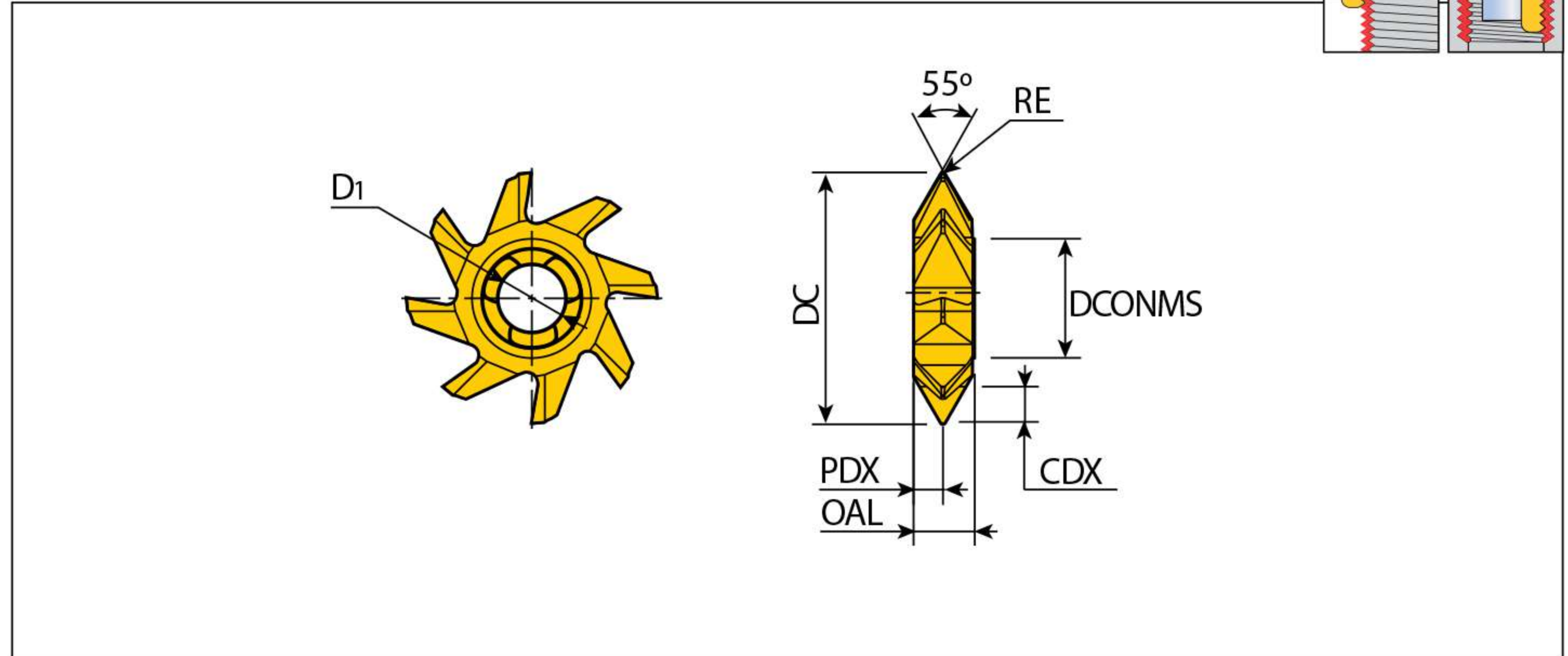

Designation	TPI	Dimension (mm)									Grade
		DC	DMIN	NOF	PDX	RE	D1	CDX	OAL	DCONMS	
<b>TR 13-T-24.7-W55-3T</b>	5-3	24.7	36	6	2.2	0.5	7.5	3.5	7.7	13	●
<b>15-T-31.7-W55-4T</b>	6-4	31.7	46	8	3.7	0.5	8.4	4.7	7.7	15	●
<b>17-T-39.7-W55-3T</b>	4-3	39.7	57	10	4.5	0.8	9.8	6.2	9.5	17	●

- TPI: Threads per inch
- NOF: Number of flutes

•: Standard items

### TR-T-M60



Interchangeable solid carbide threading heads - 60° partial profile

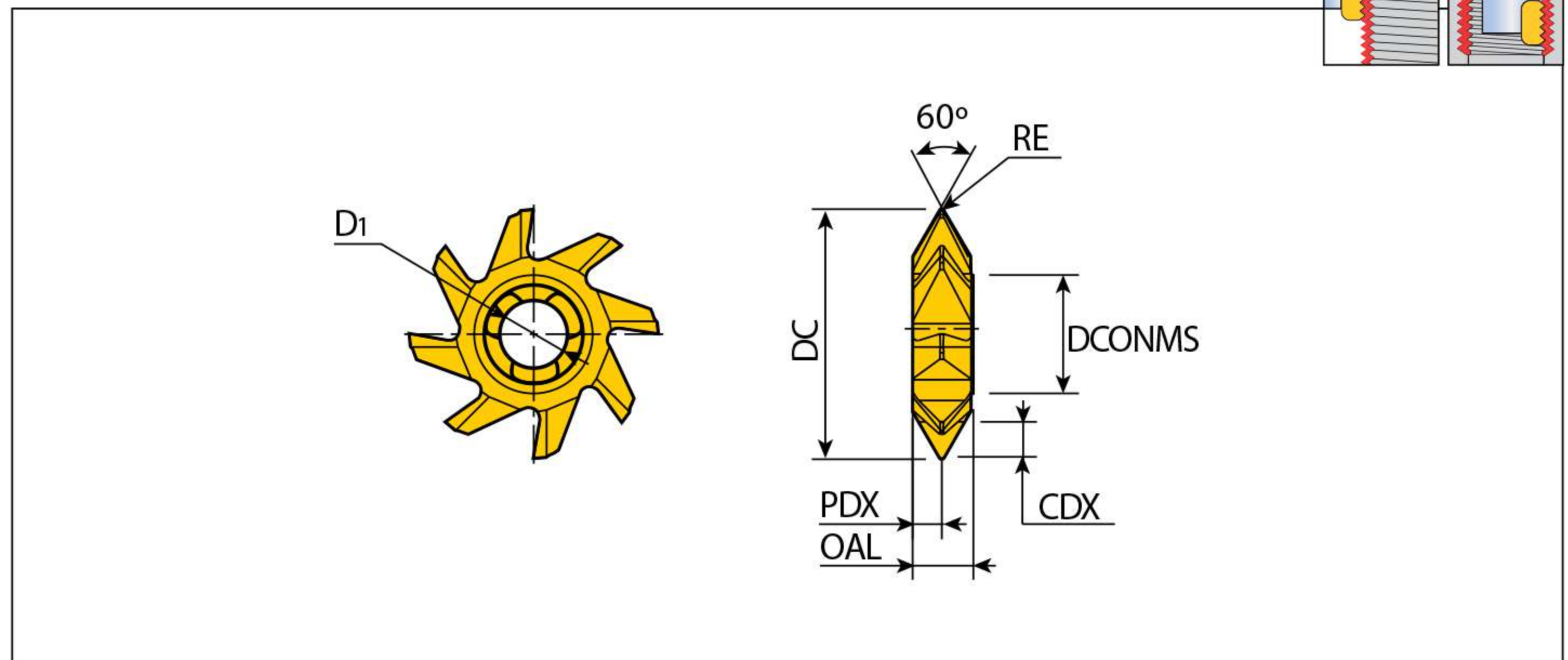

Designation	TP	TPI	Dimension (mm)									Grade
			DC	DMIN	NOF	PDX	RE	D1	CDX	OAL	DCONMS	
<b>TR 13-T-24.7-M60-5P</b>	3-5	5-3	24.7	36	6	2.2	0.2	7.5	3.5	7.7	13	●
<b>15-T-31.7-M60-6P</b>	4-6	6-4	31.7	46	8	3.7	0.3	8.4	4.7	7.7	15	●
<b>17-T-39.7-M60-8P</b>	6-8	4-3	39.7	57	10	4.5	0.4	9.8	6.2	9.5	17	●

- TP: Threads pitch, TPI: Threads per inch
- NOF: Number of flutes

•: Standard items

### TR



#### Slotting & threading holders

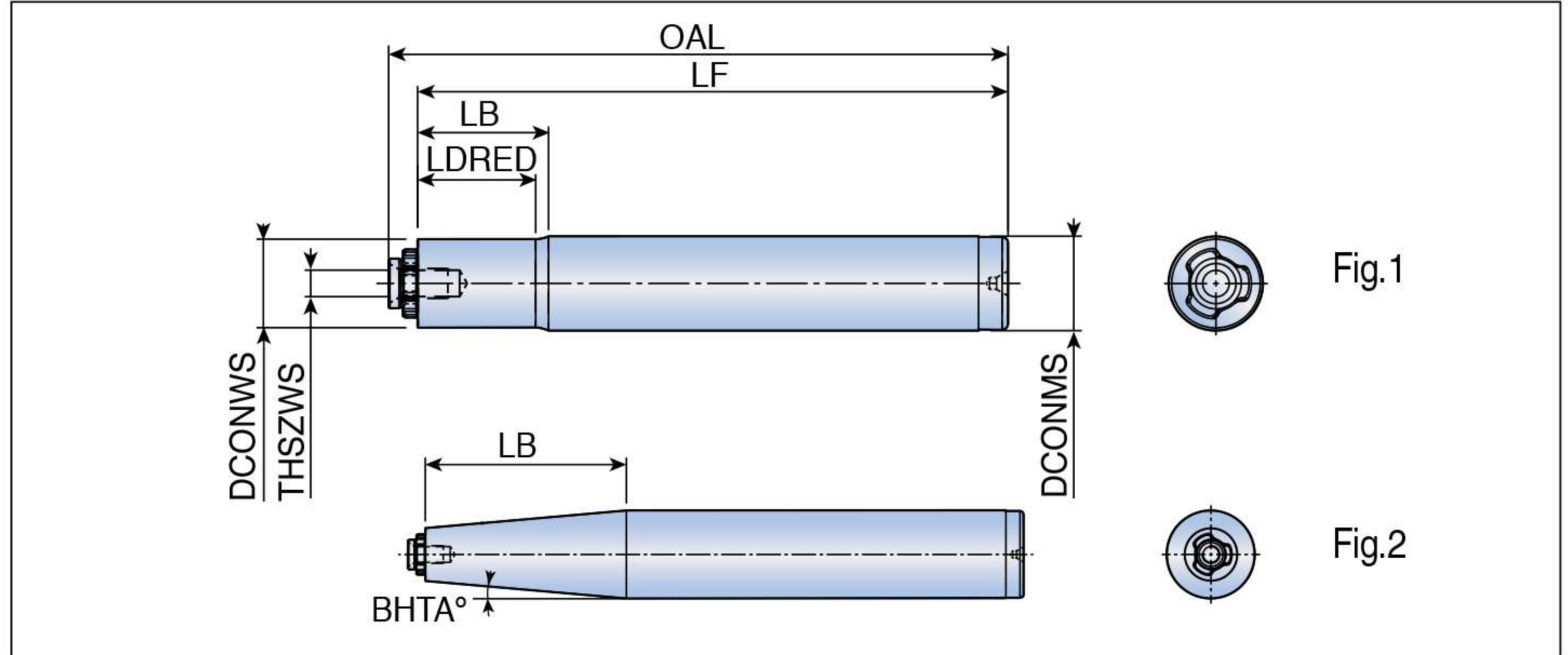

Designation	Dimension (mm)									Coolant	Fig.	Head
	DCONMS	DCONWS	LB	LF	OAL	THSZWS	LDRED	BHTA°				
<b>TR 13-16-L100</b>	16	13	16.6	100	104.35	M4x0.5	13.0	-	x	1	TR-S..	
<b>15-16-L100</b>	16	15	18.2	100	104.90	M5x0.5	16.0	-	x	1	TR-T..	
<b>15-16-L130</b>	16	15	18.2	130	134.90	M5x0.5	16.0	-	x	1	4T-TSM-TR...	
<b>17-20-L140</b>	20	17	23.8	140	146.00	M6x0.5	20.2	-	x	1		
<b>15-25-TC170</b>	25	15	57.2	170	174.90	M5x0.5	-	5	x	2		

#### Spare parts

Designation	Screw	Wrench	Wrench handle		
<b>TR13</b>	TS 40T098/HG-P	BLD IP15/S7	SW6-T		
<b>TR15</b>	TS 50T110/HG-P	BLD IP20/S7	SW6-T		
<b>TR17</b>	SR M6X0.5-SP1719-IP25-H	BLD IP25/S7	SW6-T		

### TR-F-C



#### Facing holders

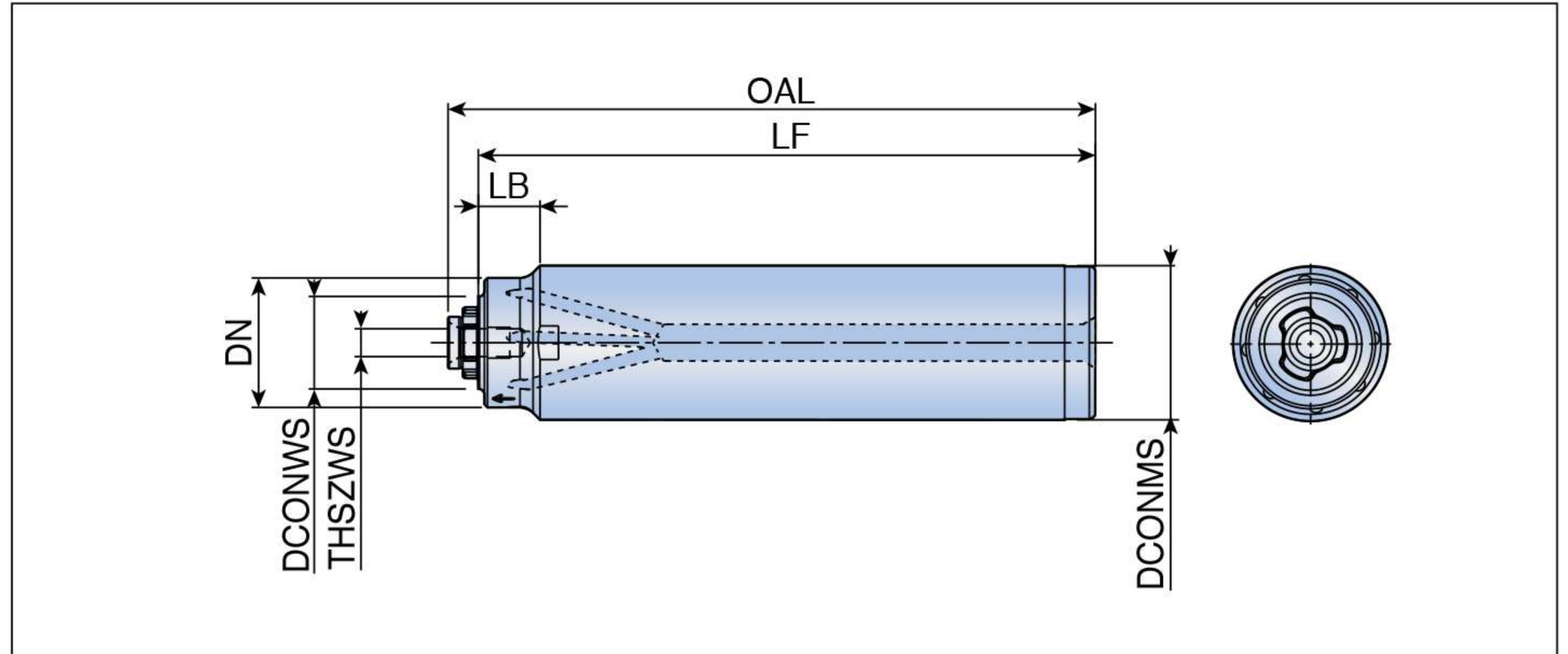

Designation	Dimension (mm)							Coolant	Head
	DCONMS	DCONWS	LB	LF	OAL	THSZWS	DN		
<b>TR13-20-L100-F-C</b>	20	13	10.0	100	104.35	M4x0.5	16	●	TR-F....
<b>13-25-L100-F-C</b>	25	13	12.5	100	104.35	M4x0.5	16	●	4T-TE90-TR...
<b>15-25-L100-F-C</b>	25	15	10.0	100	104.90	M5x0.5	21	●	
<b>15-32-L110-F-C</b>	32	15	13.5	110	114.90	M5x0.5	21	●	
<b>17-32-L140-F-C</b>	32	17	10.0	140	146.00	M6x0.5	28	●	
<b>17-42-L140-F-C</b>	42	17	15.0	140	146.00	M6x0.5	28	●	

#### Spare parts

Designation	Screw	Wrench	Wrench handle		
<b>TR13</b>	TS 40T098/HG-P	BLD IP15/S7	SW6-T		
<b>TR15</b>	TS 50T110/HG-P	BLD IP20/S7	SW6-T		
<b>TR17</b>	SR M6X0.5-SP1719-IP25-H	BLD IP25/S7	SW6-T		



### TR-ER-C new



#### ER collet chuck adaptors

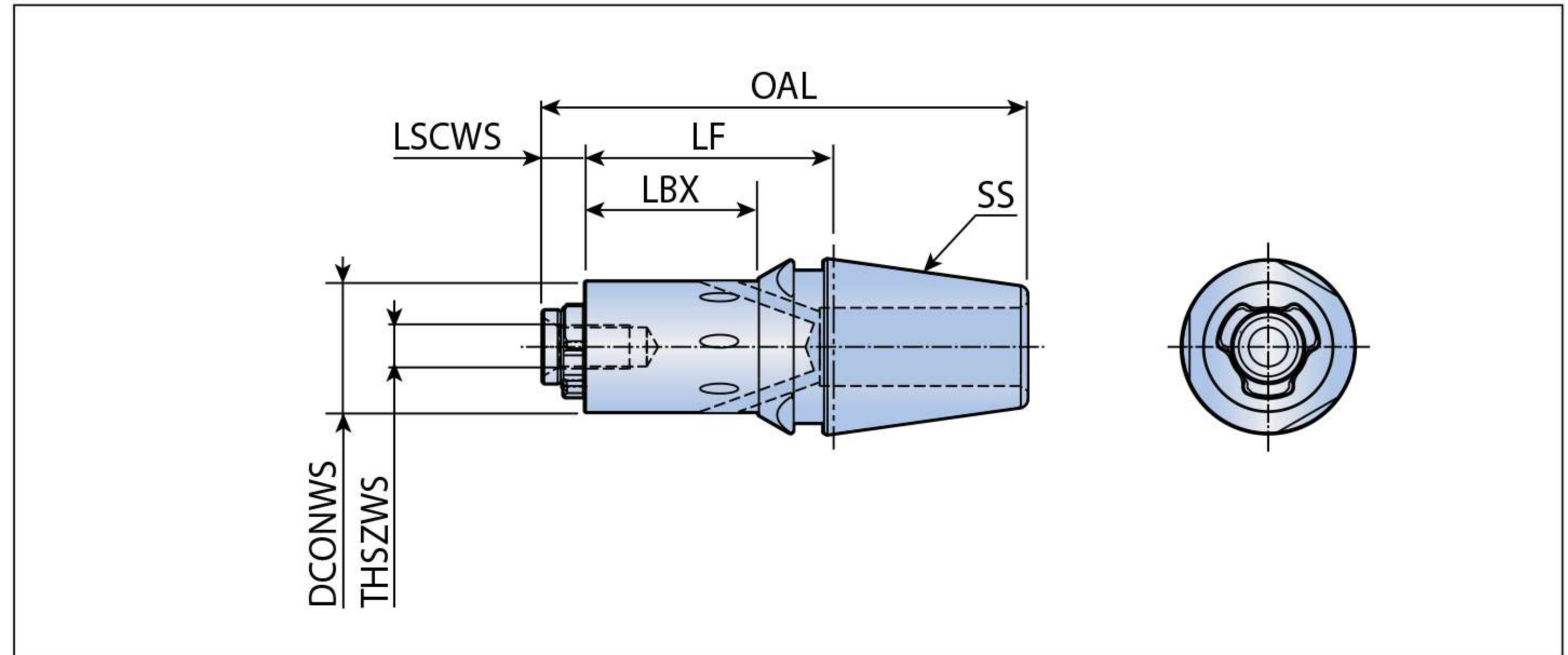

Designation	Dimension (mm)							Coolant	Head
	SS	DCONWS	LBX	LF	OAL	THSZWS	LSCWS		
<b>TR 13 ER20-H20-C</b>	ER20	13	20	28.6	55.4	M4x0.5	4.4	●	TR-S/F/T...
<b>15 ER20-H20-C</b>	ER20	15	20	28.6	55.9	M5x0.5	4.9	●	4T-TSM/TE90-TR...
<b>13 ER25-H20-C</b>	ER25	13	20	29.1	58.4	M4x0.5	4.4	●	
<b>15 ER25-H20-C</b>	ER25	15	20	29.1	58.9	M5x0.5	4.9	●	
<b>17 ER25-H20-C</b>	ER25	17	20	29.1	60.0	M6x0.5	6.0	●	
<b>13 ER32-H20-C</b>	ER32	13	20	30.1	64.4	M4x0.5	4.4	●	
<b>15 ER32-H20-C</b>	ER32	15	20	30.1	64.9	M5x0.5	4.9	●	
<b>17 ER32-H20-C</b>	ER32	17	20	30.1	66.0	M6x0.5	6.0	●	
<b>17 ER40-H20-C</b>	ER40	17	20	32.2	72.0	M6x0.5	6.0	●	

#### Spare parts

Designation	Screw	Wrench	Wrench handle		
<b>TR13</b>	TS 40T098/HG-P	BLD IP15/S7	SW6-T		
<b>TR15</b>	TS 50T110/HG-P	BLD IP20/S7	SW6-T		
<b>TR17</b>	SR M6X0.5-SP1719-IP25-H	BLD IP25/S7	SW6-T		

### Recommended Cutting Conditions

ISO	Material			Vc(m/min)	f (mm/tooth)		
	Material	AISI/SAE/ASTM	HB		TR13	TR15	TR17
P	Non-alloy steel	1020	130-180	120-200	0.04-0.12	0.05-0.15	0.06-0.15
	Low alloy steel	4030	260-300	200-300	0.04-0.12	0.05-0.15	0.06-0.15
	Low alloy steel	3135	HRC 35-40	80-120	0.02-0.06	0.03-0.12	0.04-0.12
	High alloy steel	H13	200-220	100-150	0.03-0.07	0.04-0.12	0.04-0.12
M	Martensitic stainless steel	420	200	100-150	0.02-0.06	0.04-0.12	0.04-0.12
	Austenitic stainless steel	304L	200	80-120	0.02-0.06	0.03-0.10	0.03-0.12
K	Gray cast iron	Class 40	250	150-200	0.04-0.12	0.05-0.20	0.05-0.20
	Malleable cast iron	Class 65 45 12	200	130-180	0.04-0.10	0.05-0.18	0.05-0.18
S	High temp. alloys	Inconel 718	HRC 36-40	20-30	0.015-0.10	0.02-0.12	0.02-0.12
		AMS R56400	HRC40-45	30-40	0.015-0.06	0.02-0.12	0.02-0.12

■ Steel   
 ■ Stainless steel   
 ■ Cast iron   
 ■ High temp. alloys

# CONTACT US



## MEGA TECH METALWORK CO.,LTD ( Headquarter )



**Tel : 02-943-1591**



**Fax : 02-943-1592**



**Line ID : @mgt\_metalwork**



**Email : sales.m@mgtg.co.th**



**Web : <https://www.mgtg.co.th/>**



**17/4 Soi Ramintra 89  
Ramintra Khannayao  
Bangkok 10230**

